

CARACTERISTICAS

MATERIAL boca: fundicion de hierro GG-20 perlítica
cuerpo: chapa de acero zincado
contenedor interior: chapa de acero galvanizado

ACABADO pintado

COLOR exterior: negro forja o efecto cor-ten
interior: gris RAL 7073, amarillo RAL 1004,
azul RAL 5012 o verde RAL 6018

COLOCACION anclaje mediante 4 pernos M-14, 230mm de largo

PESO 84 kg

CAPACIDAD 40 litros

MATERIAL *mouth: GG-20 pearlitic cast iron
body: zinc plated steel sheet
inside container: galvanized steel sheet*

FINISH *paint coated*

COLOUR *exterior: forge black or cor-ten effect
interior: grey RAL 7073, yellow RAL 1004, blue RAL 5012 or green RAL 6018 anchored with 4 bolts M-14, 230mm longer 84 kg*

FIXING *4 bolts M-14, 230mm longer 84 kg*

WEIGHT 40 litres

CAPACITY

DISEÑO IDESIGN Pep Zzurca

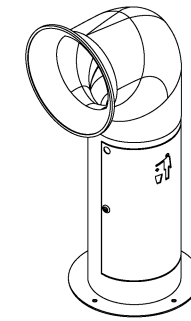

SISTEMA DE COLOCACION

elevación / *hoisting*
(P = 84 kg)

eslingas de poliéster /
polyester slings

Taladrar el pavimento Ø16mm /
drill pavement Ø16mm

rellenar con adhesivo químico /
fill with chemical adhesive

encajar la papelera /
insert the bin

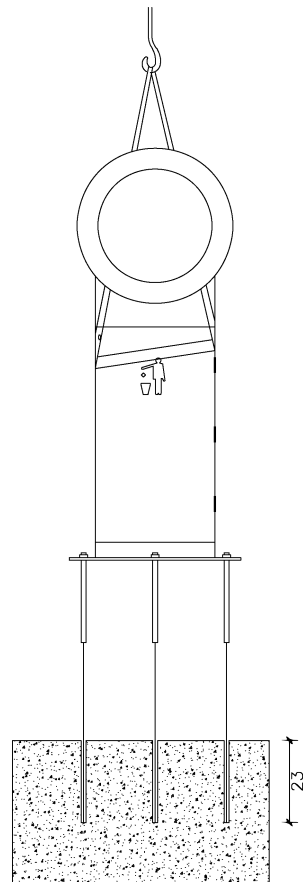
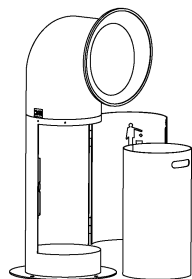
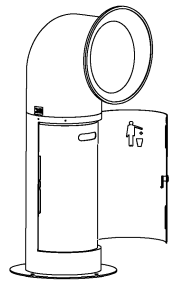

GEOMETRIA

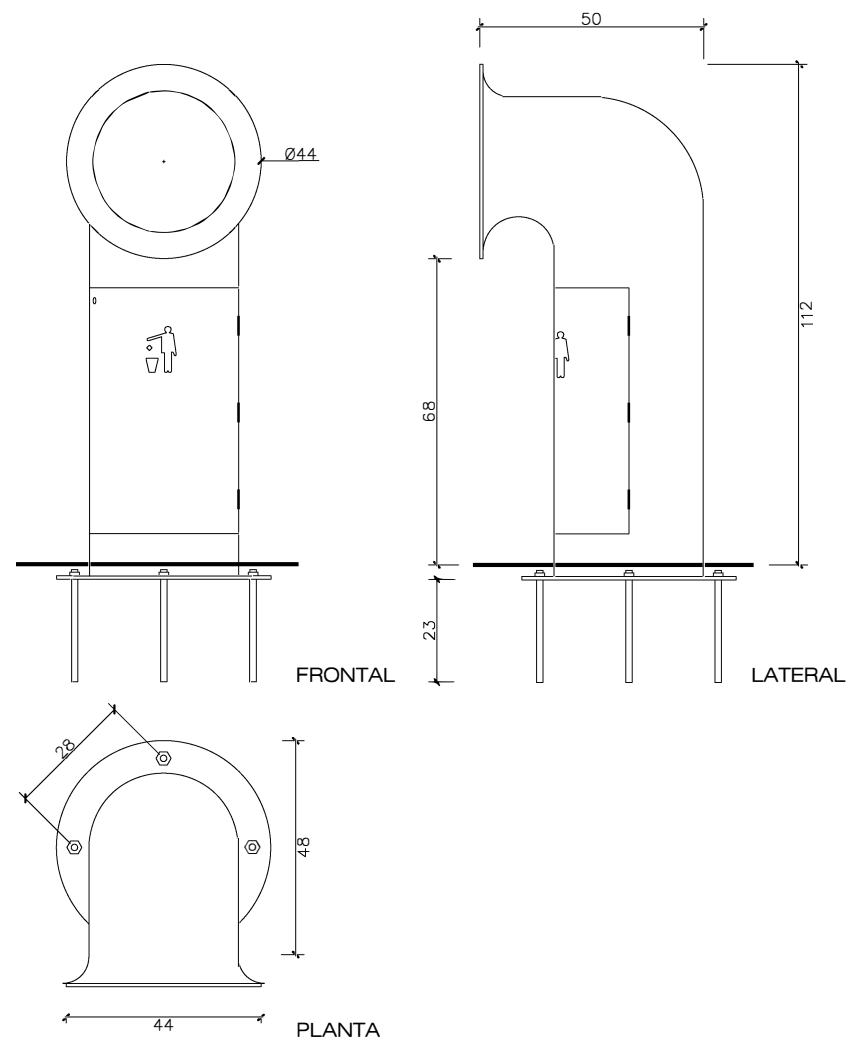

ESCALA 0 CM 25CM

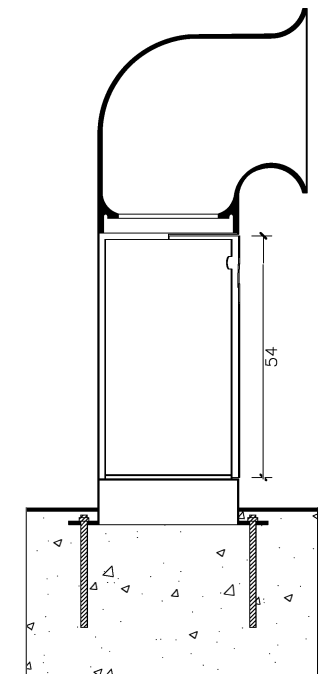

SECCION